

Products Description

This tubular lug is designed to connect cable.

It is made of tinned copper (by electrolysis).

It is manufactured with an inspection hole and socketing.

This lug meets the requirement of the NFC 20-130 standard.

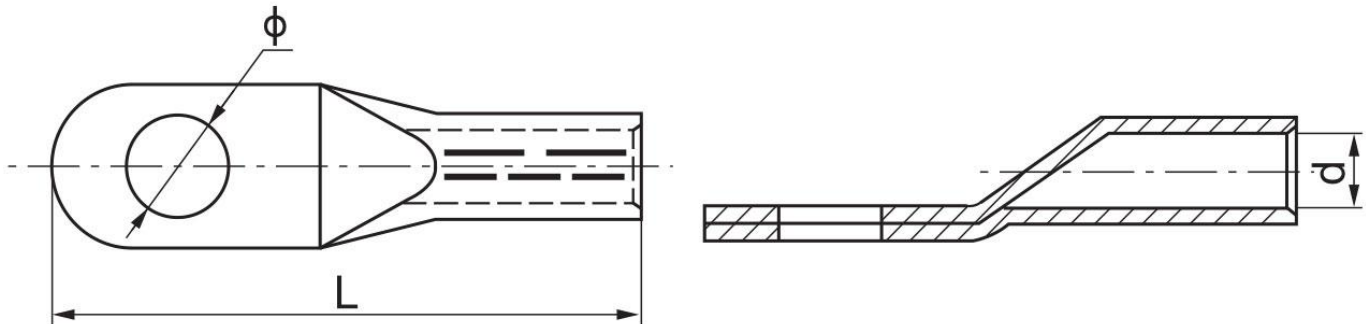

Model	Dimensions			
	L	d	B	φ
UNI-16-6	70	5.8	16	6.5
UNI-16-8	70	5.8	16	8.5
UNI-25-8	75	7.2	17.5	8.5
UNI-35-8	85	8.5	20	8.5
UNI-35-10	85	8.5	20	10.5
UNI-50-10	90	9.7	23	10.5
UNI-70-12	100	11.5	26	12.5
UNI-95-12	110	13.5	28	12.5
UNI-120-14	120	15	31	14.5
UNI-150-14	125	16.5	35	14.5
UNI-150-16	125	16.5	35	17
UNI-185-16	133	18.5	37.5	17
UNI-240-16	140	21	40	17
UNI-300-18	160	23.5	44.5	18.5
UNI-300-20	160	23.5	44.5	21